

# ezyLiv+ Camera

## Quick Installation Guide

### EZ-R33T

**Thank you for choosing CP Plus ezyLiv+ camera.**

Get Started using your new devices by downloading ezyLiv+ app, one convenient app that manages everything straight from your smart phone. Easily connect to 4G/5G SIM network and control multiple devices from the touch of your fingertips

### What's in the Box



**ezyLiv+ 4G Camera**

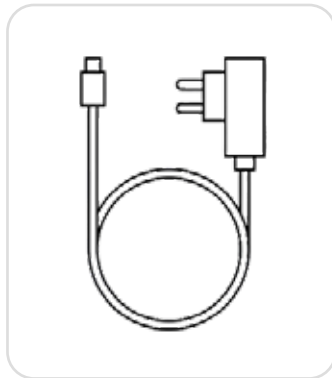

**Power Adapter**



**Screw**



**Scan QR Code to  
Download Quick  
Installation Guide**

### Get Ready

- Make sure 4G/5G SIM has valid Data Pack.
- Make sure your mobile device is running iOS 12 or higher or Android 10 or higher.

1. Download the ezyLiv+ app from App Store or Google Play.

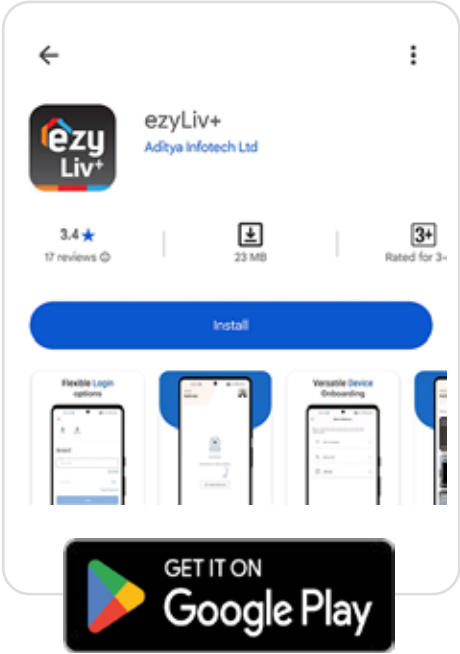

2. Register your account on ezyLiv+ application.

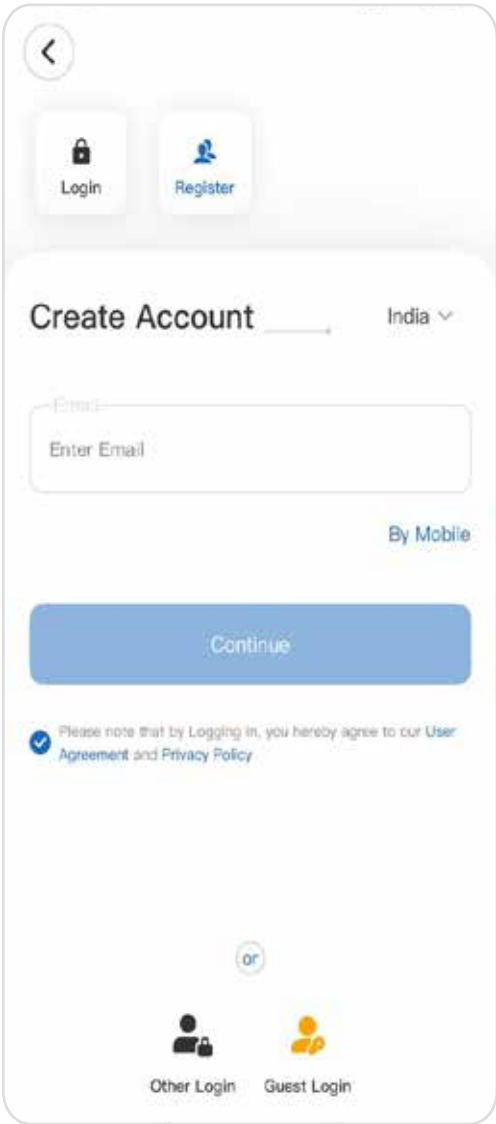

STEP 1

Select the country.  
Enter the email address.

## STEP 2

Enter the verification code  
and create a password.

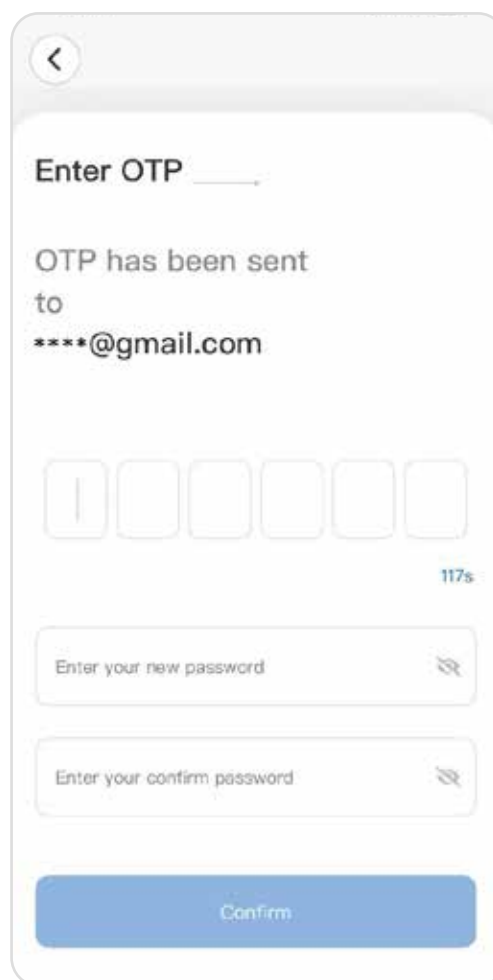

The image shows a mobile application interface for a security setup. At the top, there is a back arrow icon. Below it, the text "Enter OTP" is followed by a line for input. A message states "OTP has been sent to \*\*\*\*@gmail.com". Below this is a row of six input boxes for the verification code, with a timer "117s" to the right. Further down are two password input fields labeled "Enter your new password" and "Enter your confirm password", each with a toggle icon. At the bottom is a large blue button labeled "Confirm".

## 3. Plug in

### How do I reset my camera?

Uncover the rubber protection on the bottom of camera. Locate SIM Slot with marking to insert the SIM card.

Optional:

Insert Micro SD card.

Reset Button, Press the reset button for 15 seconds until you hear the beep.



## 4. Add Camera

Open ezyLiv+ app, click "+" on the top right corner of the "Home" page, then select "Specific Device type to add".

(Insert 4G/5G SIM card in camera then Power ON the camera and wait for the camera to give audio prompt "4G connection successful".)

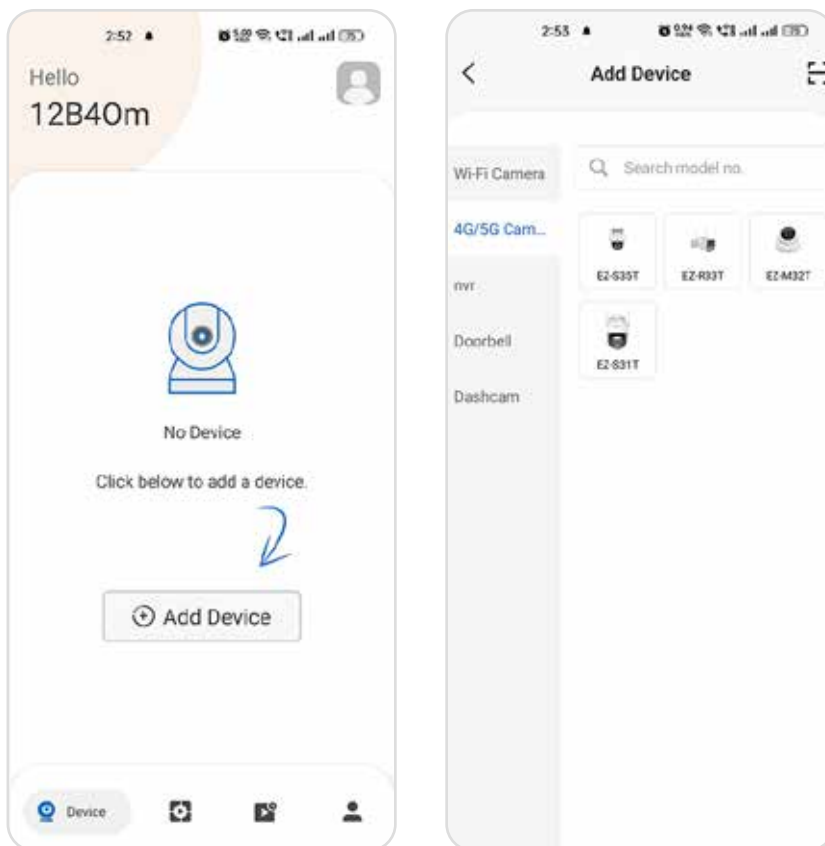

Scan the QR Code on the Camera Label sticker.

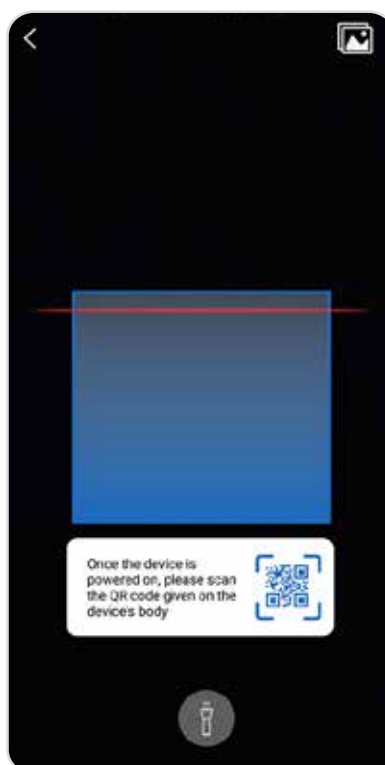

## 4.1 Add Camera

When the indicator light on the device turn to steady blue light, the network configuration is completed. Please refer to the specific App interface if there are any difference.

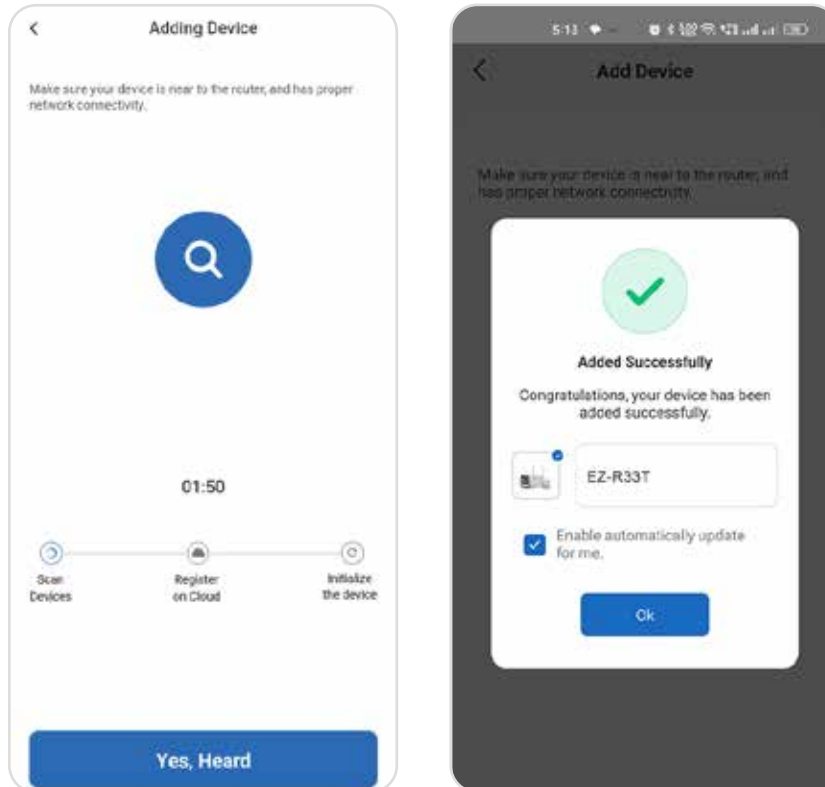

## Frequently Asked Questions

### 1. Can I share camera with family and friends?

Yes, you can share your camera with family and friends who will have access to view the camera.

### 2. Can I access 4G Camera online without SIM card?

Yes, You need to connect 4G camera with LAN cable to your Router to have internet access then only you will be able to access the 4G camera online.

### 3. Why 4G camera appears offline or unreachable.

Make sure 4G cameras is installed in 4G network range. Used 4G/5G SIM has valid Data Pack.

### 4. How many cameras can I control?

ezyKam+ app can control unlimited number of cameras in unlimited number of locations. Your router may have a limit of how many cameras can be connected to one router.

## Voice control work with Google Assistant



## Technical Specifications

- **Resolution:**

EZ-R33T= 2304x1296@15fps, H.265 encoding

- **Field of view:**

EZ-R33T= 86.2° (H), 46.1° (V), 102.6° (D)

- **Audio:** Internal Speaker and Microphone. Make sure 4G/5G SIM has valid Data Pack.
- **Storage:** supports up to 256GB Micro SD card (not Included)



**The Future of Smart Living**

For further assistance, you can reach us via

[support@ezyliv.com](mailto:support@ezyliv.com)

**\*\*Please read the instruction carefully before using the product\*\***